



ZMT Series

Mini Size Sealed Snap-acting Switches



Agency Approvals

Agency	Agency File Number
	E42363
	ENEC-04144

Specifications

Contact Rating	0.1A 125/250VAC 3A 24VDC 3A 125/250VAC 3A 24VDC 5A 125/250 VAC 3A 24VDC
Electrical Life	10,000 Cycles
Electrical Operating Frequency	10-30 operations per minute
Mechanical Life	1,000,000 operations
Mechanical Operating Frequency	120 operations per minute
Insulation Resistance	Min. 100 mΩ (500 VDC / minute) between Live-parts and dead metal parts
Dielectric Strength	500VAC (50-60HZ)/minute between contacts, 1500VAC (50-60HZ)/minute between Live-parts and dead metal parts
Operating Temperature	-40°C to 85°C (with no icing)
Operating Force	200 grams

Description

ZMT series sealed snap-acting switches are often found used in automotive interior applications where detect mechanism are required through a snap acting switch. The ZMT is perfect for PCB detection switches, communication devices and various types of testing equipment as well. Featuring a compact size and IP67 sealed (which is ideal when space is limited), the ZMT sealed series give applications a long electrical and mechanical life, ensuring they stand up to repeated use.

Features & Benefits

- IP67 rating / Dust tight protection
- From 0.1A to 5A max. (ultra-low current available)
- UL / ENEC
- Excellent sealed solution for modules mechanisms in Automotive and Medical applications

Applications

- Automotive: door latch, seat position detection, EV charging
- Handheld devices (medical)
- Industrial equipment
- Consumer electronics

Materials

Case	PBT
Cover	
Button	
Movable Contact	AG alloy
Terminals	
Lever	Stainless Steel
Wire	PVC+CU
Lower Case	Nylon
Rubber Seal	Silicon

ZMT Series

Mini Size Sealed Snap-acting Switches



Ordering Number

Our easy build-a-switch concept allows you to mix and match options to create the switch you need. To order, select desired option from each category and place it in the appropriate box.

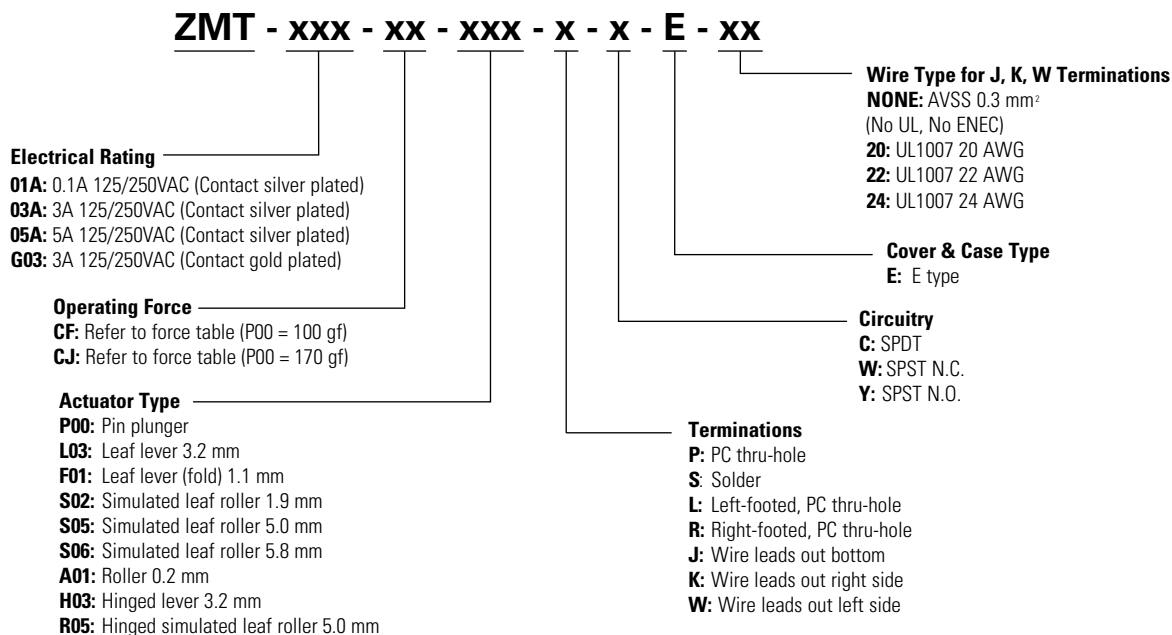

ZMT Series

Mini Size Sealed Snap-acting Switches



Series (mm)

ZMT Mini Size Sealed Snap-Acting Switches - SP Momentary

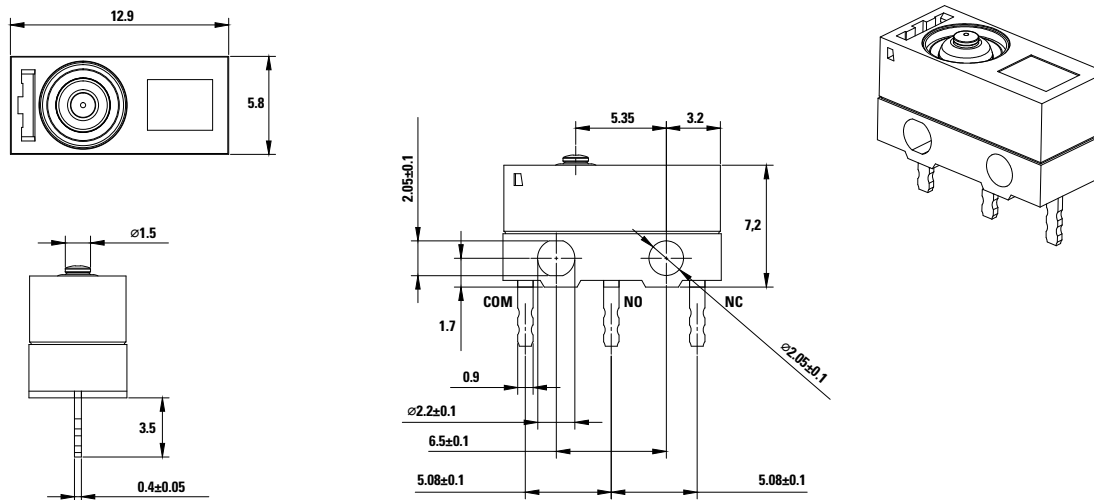

Mounting holes for PCB terminal

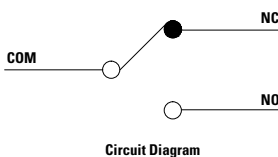
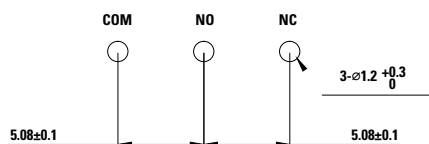

Electrical Rating

Silver Contacts

ZMT	UL1054/UL1058
01A	0.1A 125/250VAC 3A 24VDC
03A	3A 125/250VAC 3A 24VDC
05A	5A 125/250VAC 3A 24VDC

Gold Contacts

ZMT	UL1054/UL1058
G03	3A 125/250VAC 3A 24VDC

Operating Force

Operating Code	Operating force at the bottom (oz / grams)
CF	3.52 / 100
CJ	5.99 / 170

Notes: See Technical Data in section N of this catalog for RoHS compliant and compatible definition and specifications.

All models c us with all options. Consult Customer Service center for availability and delivery of non-standard ratings.

ZMT Series

Mini Size Sealed Snap-acting Switches



Actuators

P00 Pin Plunger

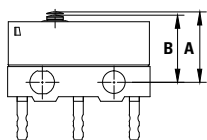

S02 Simulated Roller 1.9 mm

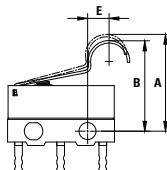

F01 Leaf Lever (fold) 1.1 mm

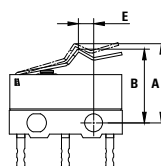

L03 Leaf Lever 3.2 mm

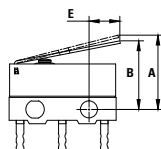

S06 Simulated Leaf Roller 5.8 mm

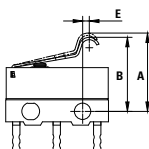

R05 Hinged Simulated Leaf Roller 5.0 mm

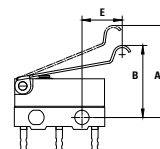

S05 Simulated Leaf Roller 5.0 mm

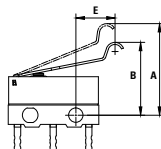

H03 Hinged Lever 3.2 mm

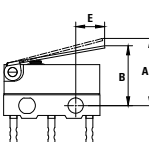

A01 Roller 0.2 mm

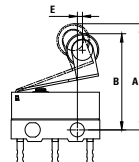

Code	Oper. Force Max. (gf)		Rel. Force Min. (gf)		A FP Max. (mm)	B OP Max. (mm)	C PT Max. (mm)	D OT Min. (mm)	E Min. (mm)
P00	100	170	21	35	6.4	5.9±0.2	0.5	0.2	-
L03	32	56	5	8	9.0	7.1±0.8	3.4	0.6	3.2
S05	28	48	5	7	13.1	9.1±0.8	3.5	0.7	5
F01	58	83	7	11	9.05	8.1±0.6	1.64	0.49	1.1
A01	45	55	4	8	15.45	13.0±1.1	3.5	0.1	0.2
S02	40	50	5	8	11.7	10.1±1.0	3.0	0.6	1.9
S06	45	65	5	12	9.85	8.5±0.8	1.8	0.25	0.1
H03	32	56	5	8	9.0	7.1±0.8	3.4	0.6	3.5
R05	28	48	5	7	13.1	9.1±0.8	3.5	0.7	5

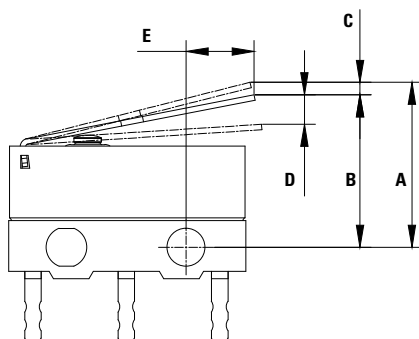

ZMT Series

Mini Size Sealed Snap-acting Switches



Terminations (mm)

P PC thru-hole

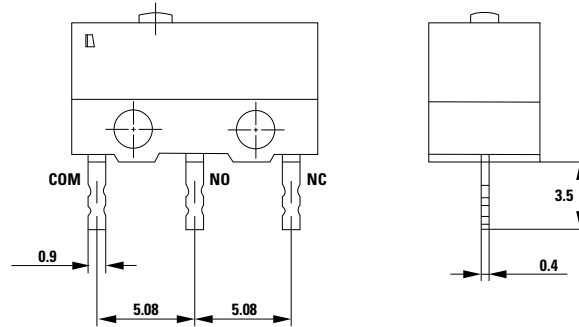

S Solder

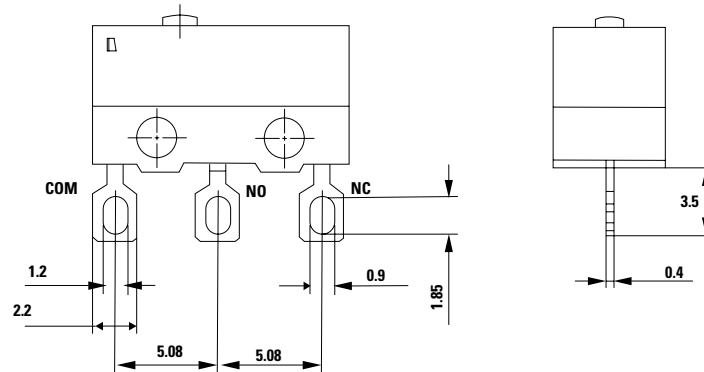

L Left-footed, PC thru-hole

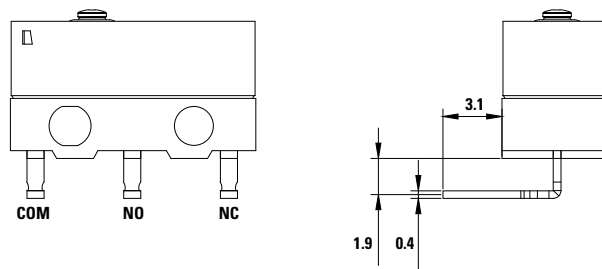

ZMT Series

Mini Size Sealed Snap-acting Switches



R Right-footed, PC thru-hole

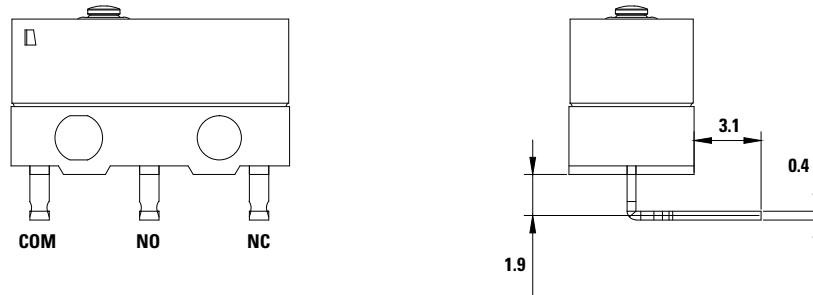

W Wire Leads Out Left Side

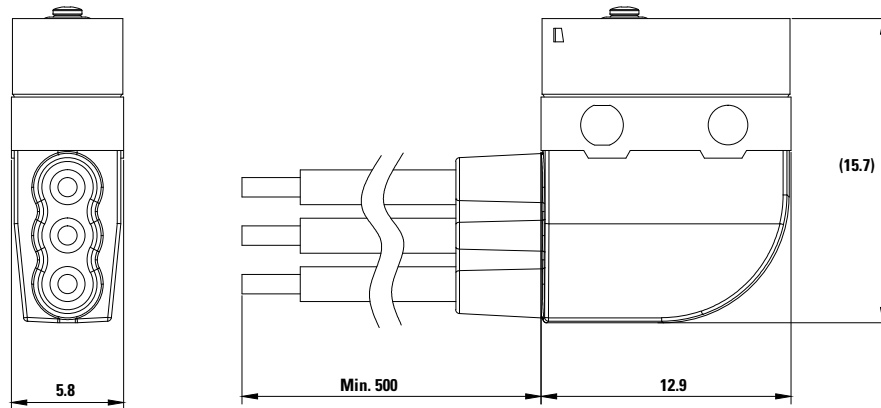

COM: UL1007 20AWG/22AWG/24AWG or equivalent (BLACK)

NO: UL1007 20AWG/22AWG/24AWG or equivalent (BLUE)

NC: UL1007 20AWG/22AWG/24AWG or equivalent (GRAY)

ZMT Series

Mini Size Sealed Snap-acting Switches



J Wire Leads Out Bottom

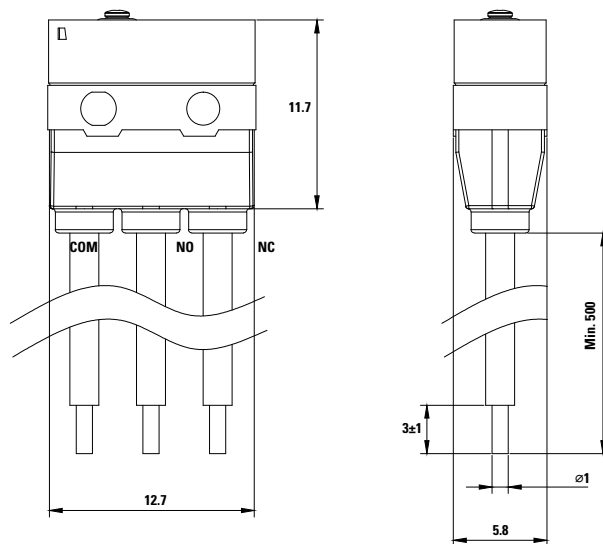

COM: UL1007 20AWG/22AWG/24AWG or equivalent (BLACK)

NO: UL1007 20AWG/22AWG/24AWG or equivalent (BLUE)

NC: UL1007 20AWG/22AWG/24AWG or equivalent (GRAY)

K Wire Leads Out Right Side

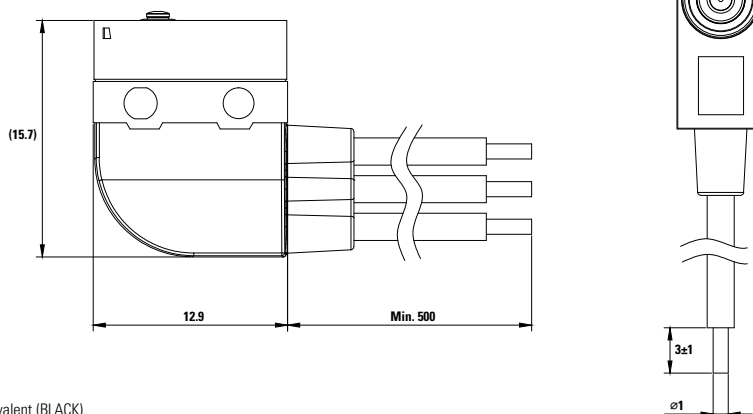

COM: UL1007 20AWG/22AWG/24AWG or equivalent (BLACK)

NO: UL1007 20AWG/22AWG/24AWG or equivalent (BLUE)

NC: UL1007 20AWG/22AWG/24AWG or equivalent (GRAY)

Circuitry

C SPDT

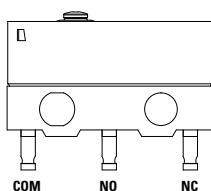

Y SPST NO

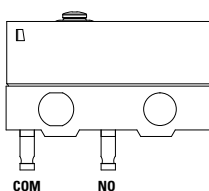

W SPST NC

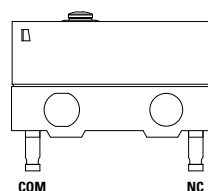

Disclaimer Notice - Information furnished is believed to be accurate and reliable. However, users should independently evaluate the suitability of and test each product selected for their own applications. Littelfuse products are not designed for, and may not be used in, all applications. Read complete Disclaimer Notice at <http://www.littelfuse.com/disclaimer-electronics>.